



6 LAMP GRATED HIGH BAY

| 6 X T8 SMD LED Tubes |

Specifications

6 X T8 SMD LED Tubes (CLGL 342 - SMD)
I-Beam fluorescent High Bay

Operating Ranges

Operating temperature range of -40 to 140°F
Operating humidity range of 10 - 99%

CLGL Design

Fixture 100% efficacy
Wide distribution (120°)
Heavy gauge steel
No ballast for quick installation of LED tube lights

Applications

Warehouse, Manufacturing, Parking Garage,
Convention Space, Lobby Lighting

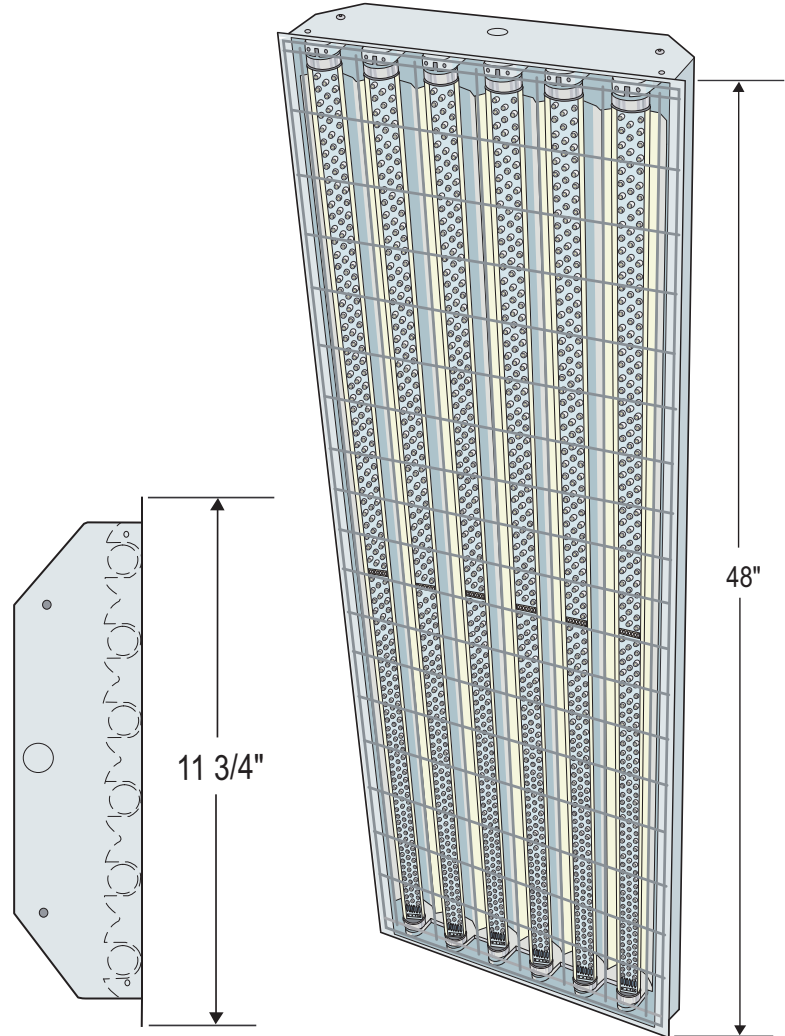

Model Details

Wattage	102
Lumens	9270
Warranty	5 Year



UL Listed



Manufactured In The USA

Ordering Information

Please Fill Out Below

Model : 6 LAMP SMD

Lamp Quantity	Glass / Poly Carb	Voltage	Lamp Color
<input type="text"/>	<input type="text" value="90 - 260V"/>	<input type="text" value="5600K"/>	<input type="text" value="5600K"/>
	Glass (G) or Poly Carb (PC)	90 - 277V, 347V	4100K (SW), 4600K (WW), 5000K (NW), 6500K (CW) Custom CCT / RGB Ranges Available